

Proposed tree plan

The site has a number of conifer trees mainly leylandi forming a hedge to the west of the site and some free standing

There are also two small fruit trees along with a large laburnum and a beech tree.

The above trees and hedging will be removed to develop the site

There is still a substantial number of trees on the remainder of the existing property at 19 Station Road Grassington and feeding and nesting stations are provided too

It is proposed to replace the hedge with beech which already exists on the roadside of the existing properties boundary at 19 Station Road.

It is intended to provide nesting boxes and feeding stations at the new property and will action any recommendations from the Planning Board

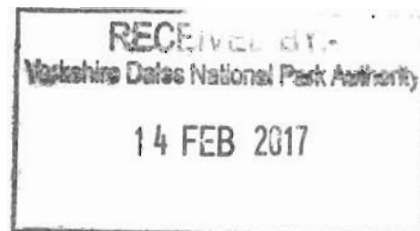

Existing tree plan

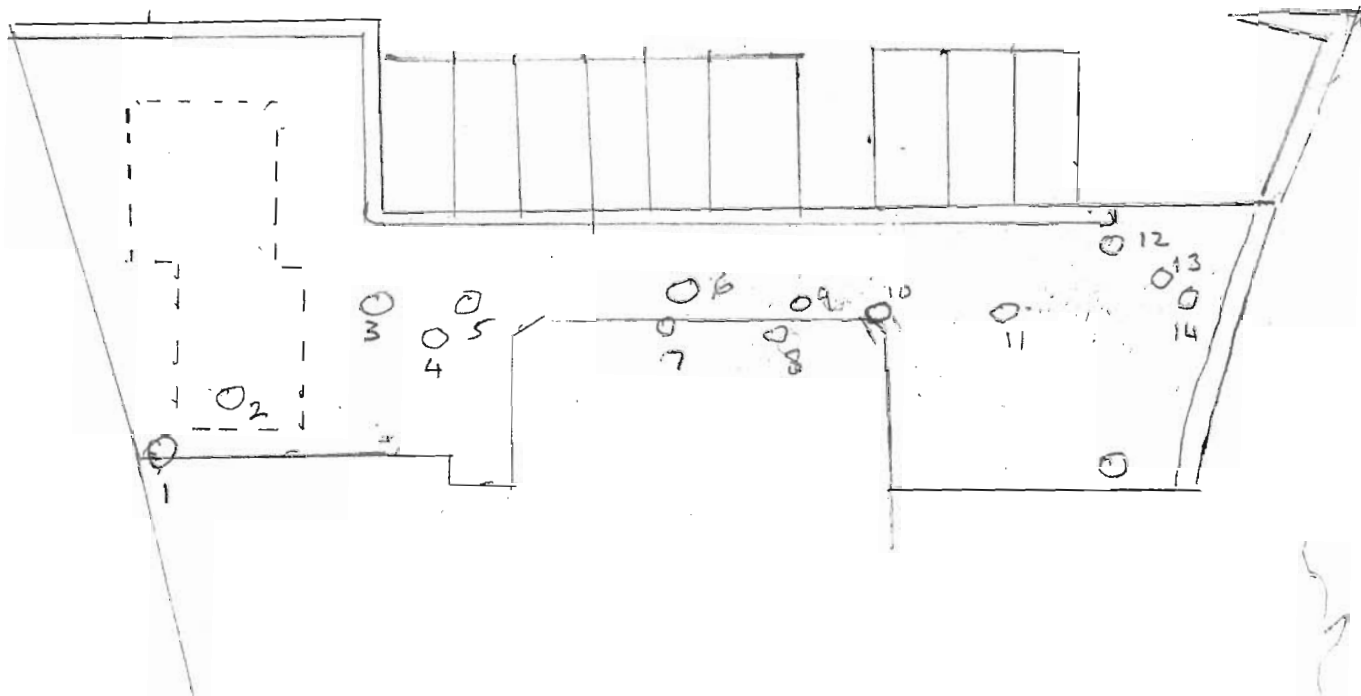

- 1-6 Coniferous
- 7-8 Small apple
- 9-11 Coniferous
- 12 Beech
- 13 Unknown ornamental
- 14 Conifer
- 15 Laburnum

Western boundary leylandi hedge

RECEIVED BY:
 Yorkshire Dates National Park Authority
 14 FEB 2017

TREE PLAN AT 19 STATION ROAD, GRASSINGTON

7/2/2017

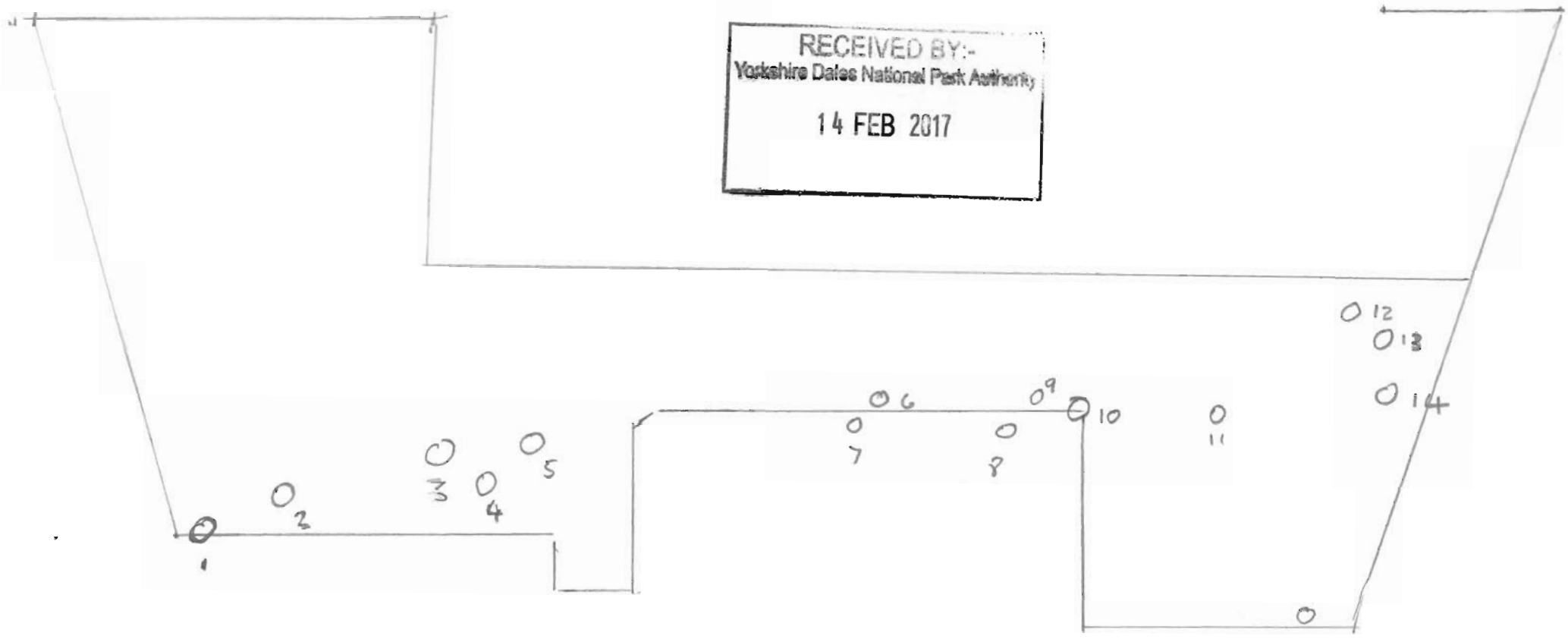

TREE PLAN AT 19 STATION ROAD, GRASSINGTON, RELATING TO ENCLOSED PHOTOGRAPHS

EXISTING TREE POSITIONS AT GROUNDS OF PROPOSED DEVELOPMENT

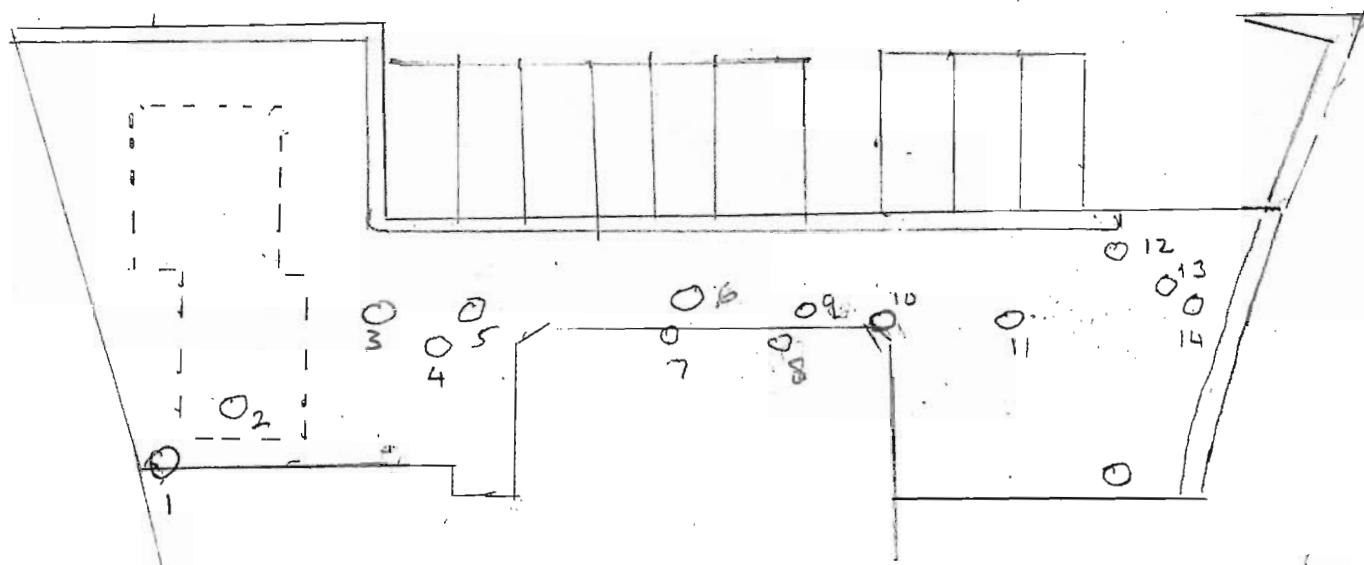

- 1-6 Coniferous (1-3 are approx 25ft high)
- 7-8 Small apple (4-11 are approx 12ft high)
- 9-11 Coniferous
- 12 Beech (12 - 25ft high)
- 13 Unknown ornamental (13 - 15ft high)
- 14 Conifer (14 - 12ft high)
- 15 Laburnum (15 - 30ft high)

Western boundary leylandi hedge

BRIDGE HOUSE
19 STATION ROAD
GRASSINGTON

TREES AT POSITIONS

1, 2, 3, 4, 5
6, 7



Trees at positions 12, 13 & 14



TREES in Position 6, 7, 8, 9, 10 and 11



TREES AT 1, 2, 3



TREES AT 12, 13, 14