

Mr S Clarkson
Holly Cottage, Hudswell
LOCATION PLAN
Scale 1/1250

RECEIVED BY:
Yorkshire Dales National Park Authority
10 JUN 2009

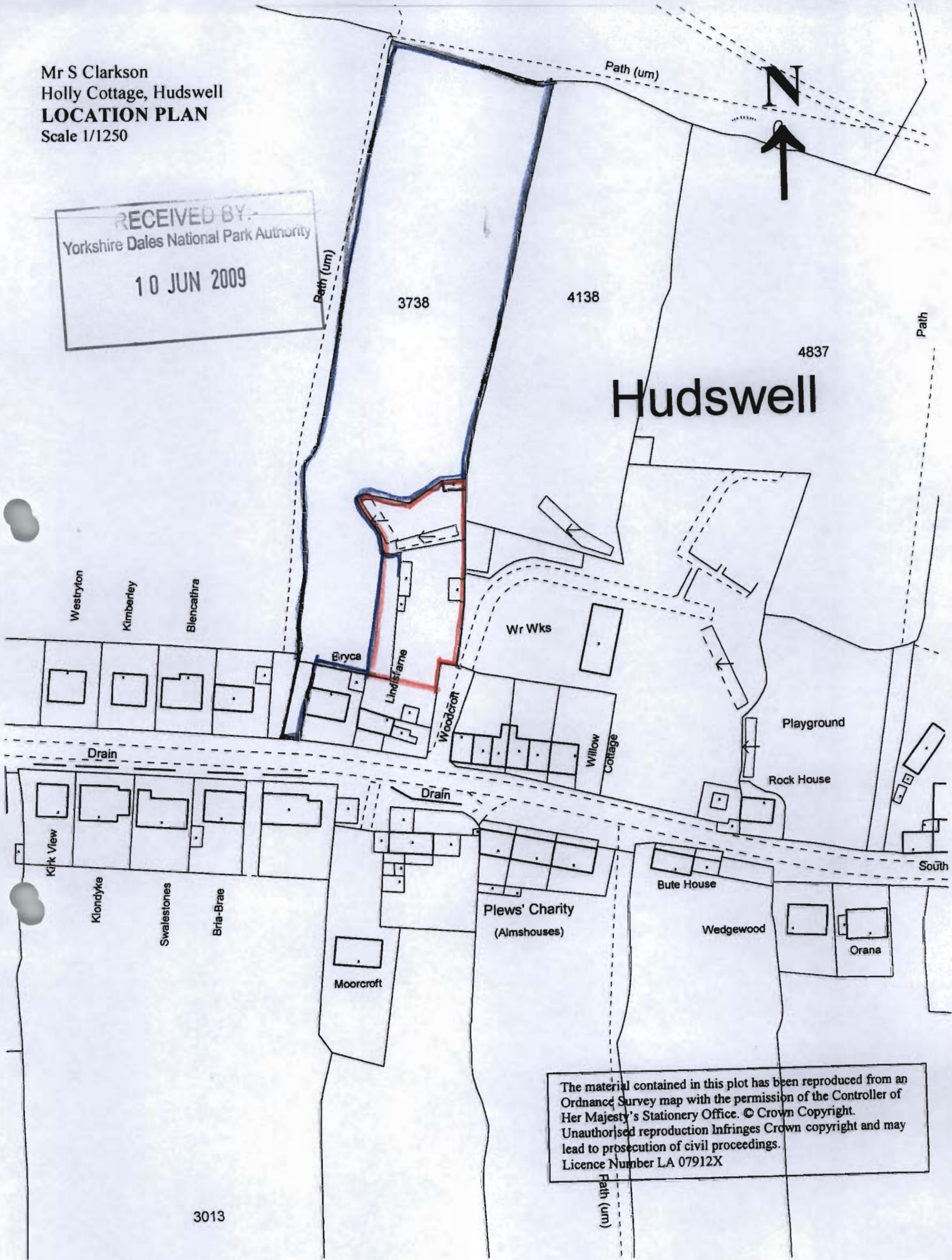

The material contained in this plot has been reproduced from an Ordnance Survey map with the permission of the Controller of Her Majesty's Stationery Office. © Crown Copyright. Unauthorised reproduction infringes Crown copyright and may lead to prosecution of civil proceedings. Licence Number LA 07912X

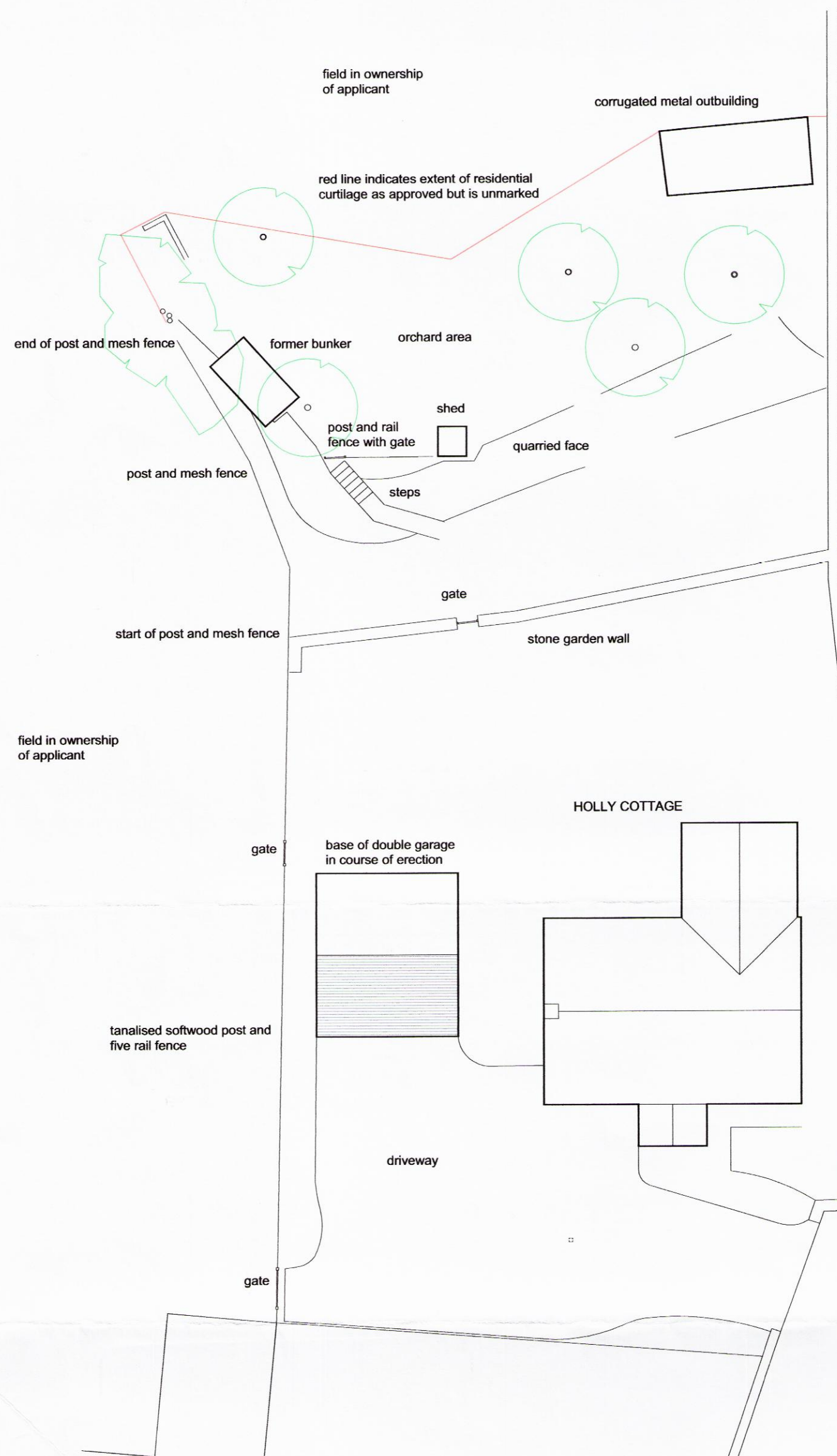

EXISTING SITE and BLOCK PLAN
Scale 1 / 200

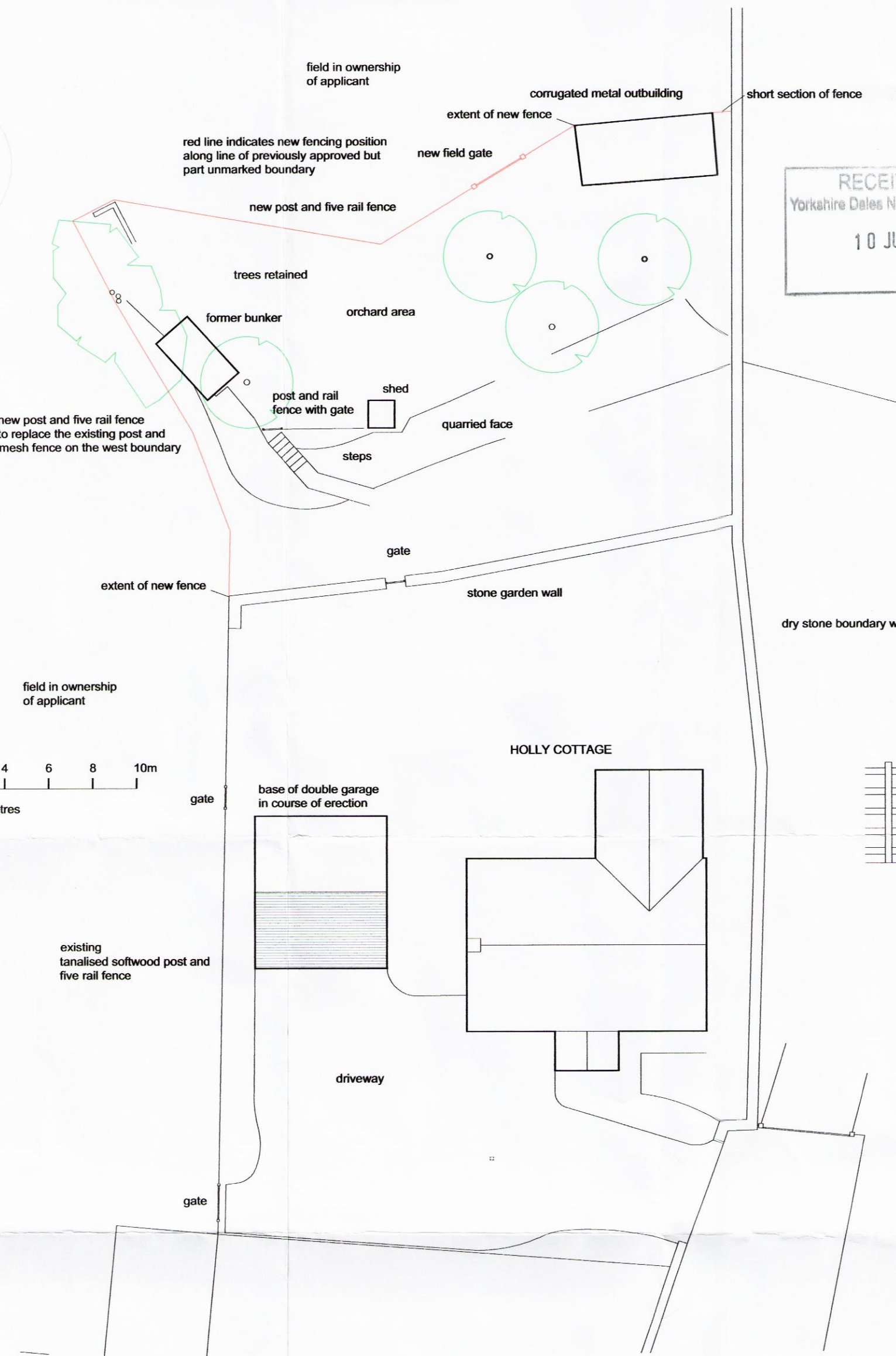
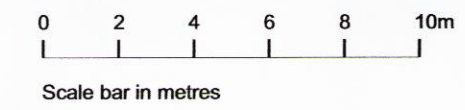
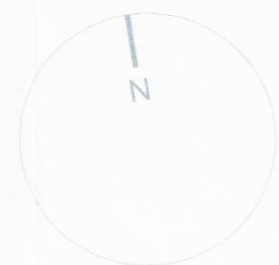

PROPOSED SITE and BLOCK PLAN
Scale 1 / 200

RECEIVED BY:-
Yorkshire Dales National Park Authority
10 JUN 2009

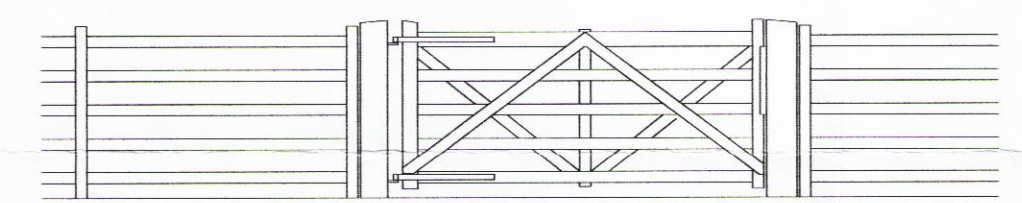

ELEVATION of GATE and FENCE
Scale 1 / 50

NOTES

fencing and gate to match type and style of existing 5 rail fencing and gates
height to match existing five rail fence on western boundary

fencing and gate woodwork in tanalised european mixed softwood
fence posts 125x75mm and gate posts 200x200mm with angled top
fence rails 75x35mm, gate top rail and hanging stile 100x75
shutting stile 75x75mm, and all remaining rails 75x25mm
galvanised steel hinges, lugs, post plates and gate latch

CLIENT Mr & Mrs S Clarkson
PROJECT HOLLY COTTAGE
HUDSWELL
Nr RICHMOND

SCALE 1/200
DATE June 2009
DRAWING NO. 1.05.7012.14

Proposed fencing and gate to
northern boundary

**JAMES HARTLEY
& SON**

ARCHITECTS & SURVEYORS
PINDER BRIDGE HOUSE
CROSS STREET
SKIPTON
NORTH YORKSHIRE
BD 2 3 2 AH
TEL & FAX 01756 793946