



# THE NATIONAL TRUST

YORKSHIRE & NORTH EAST  
REGION

Title: LOCATION PLAN  
Proposed Boiler Installation  
Malham Tarn House



Scale 1/10000  
Date 16/10/2013

Centre = 389383 E 467250 N  
User GC

© Crown copyright and database rights 2012  
Ordnance Survey 100023974

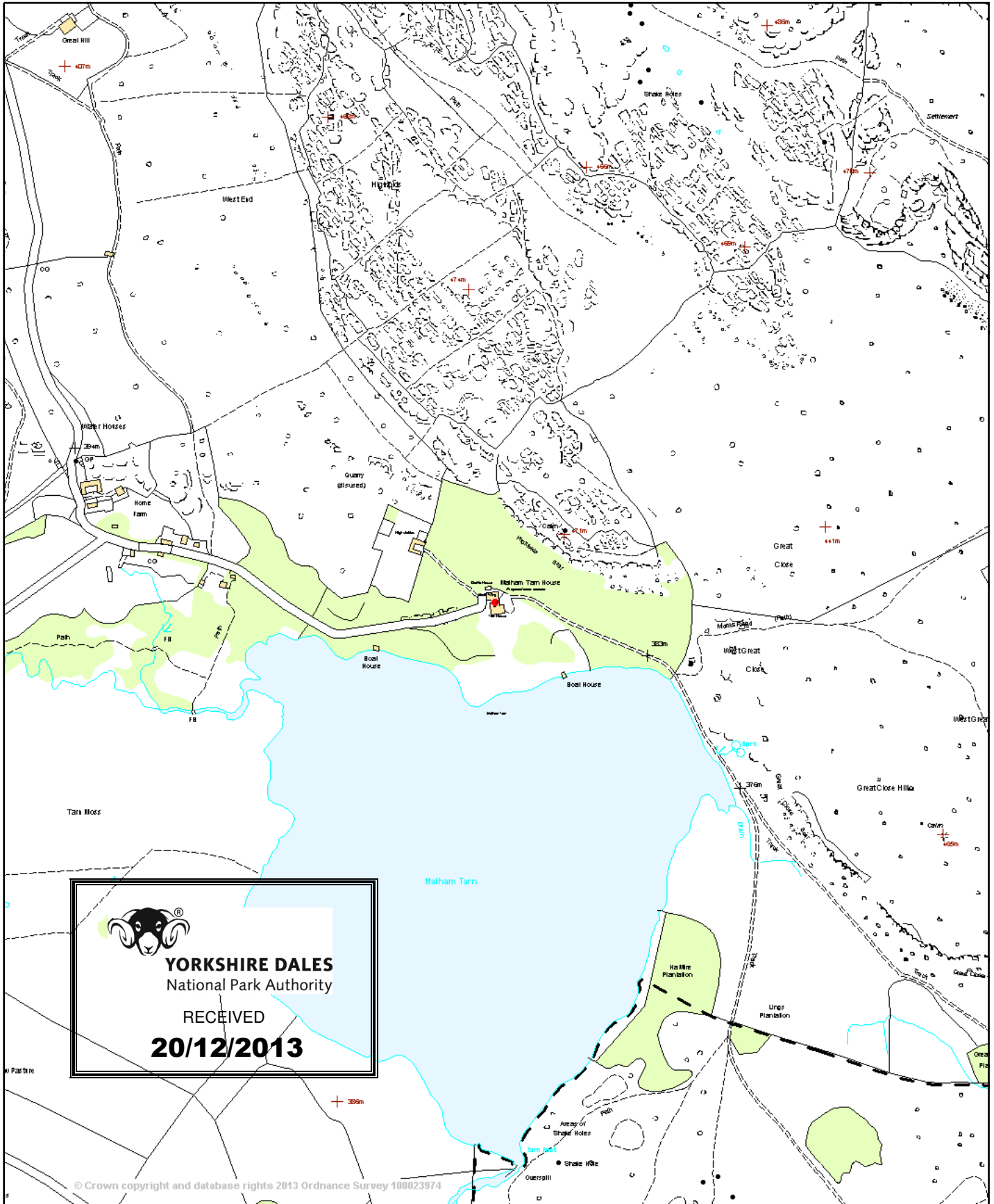

  
**YORKSHIRE DALES**  
National Park Authority  
RECEIVED  
**20/12/2013**



THE NATIONAL TRUST

YORKSHIRE & NORTH EAST  
REGION

Title: LOCATION PLAN  
Proposed Boiler Location  
Malham Tarn House



Scale 1/2500  
Date 16/10/2013

Centre = 389383 E 467250 N  
User G Campbell

© Crown copyright and database rights 2012  
Ordnance Survey 100023974



YORKSHIRE DALES  
National Park Authority

RECEIVED  
**20/12/2013**





THE NATIONAL TRUST

YORKSHIRE & NORTH EAST  
REGION

Title: Malham Tarn House  
Courtyard



Scale 1/2500

Centre = 389384 E 467217 N

Date 18/12/2013

User GC

© Crown copyright and database rights 2012  
Ordnance Survey 100023974

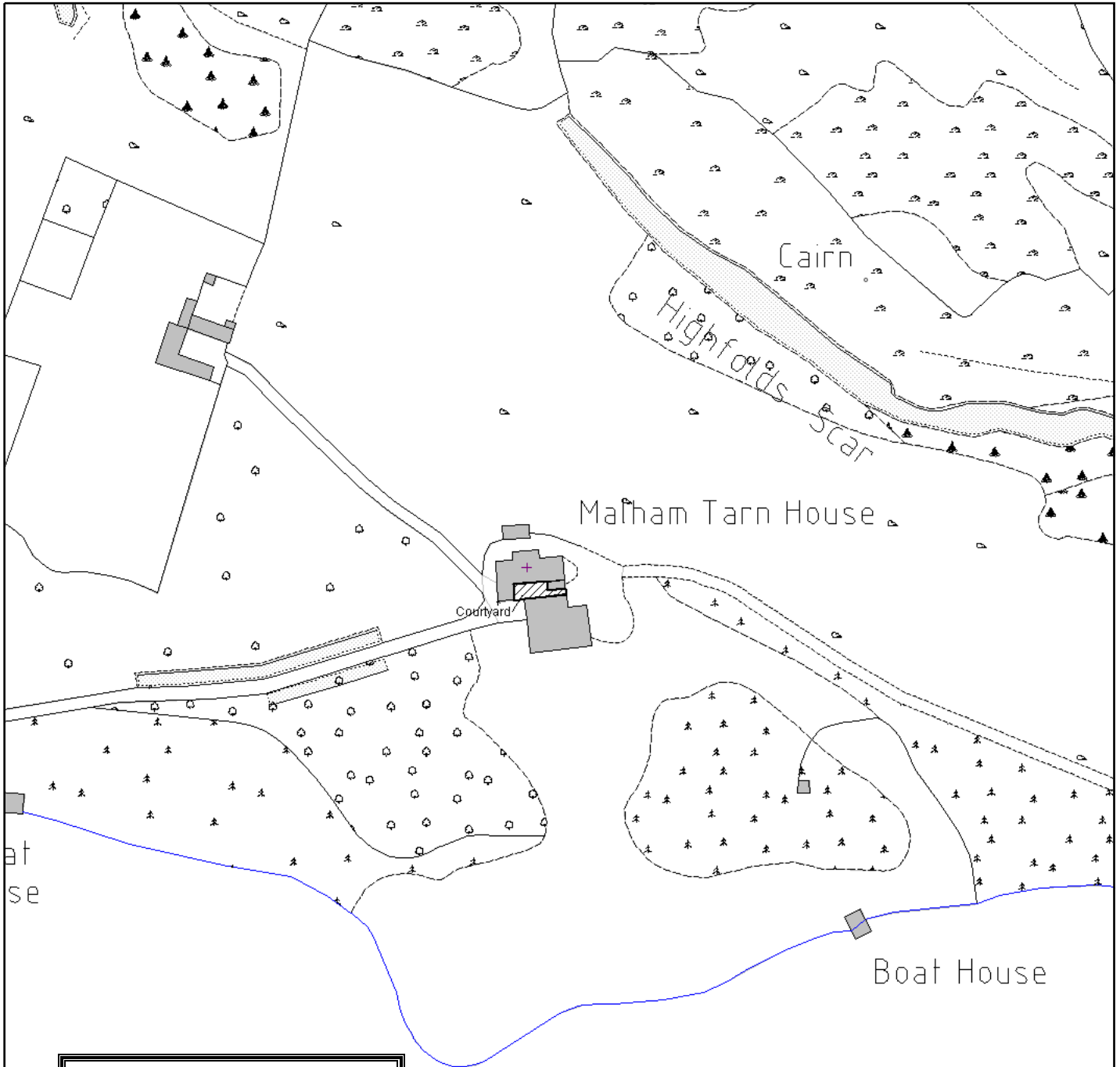

**YORKSHIRE DALES**  
National Park Authority

RECEIVED

**20/12/2013**



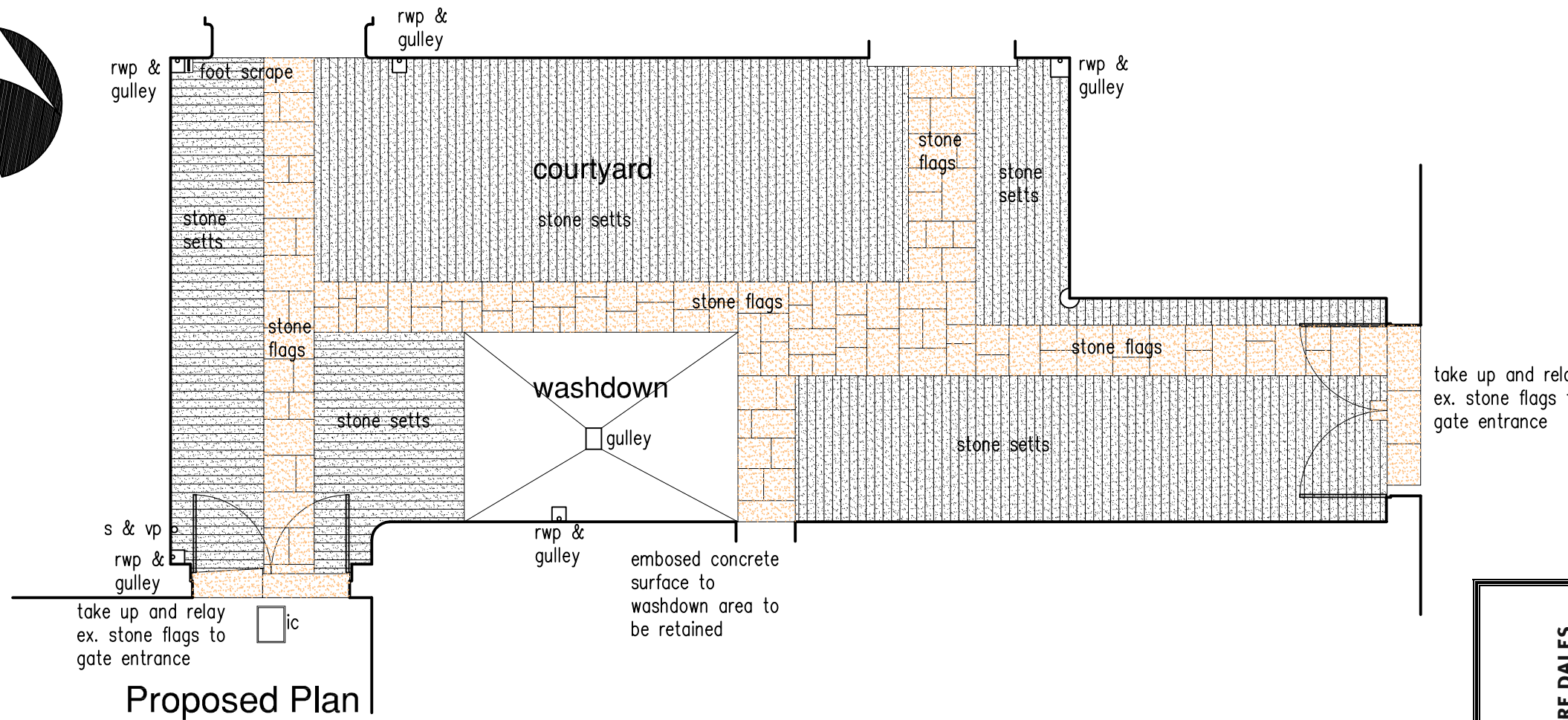
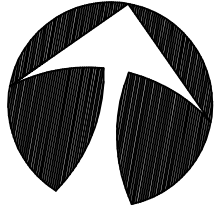

**Proposed Plan**

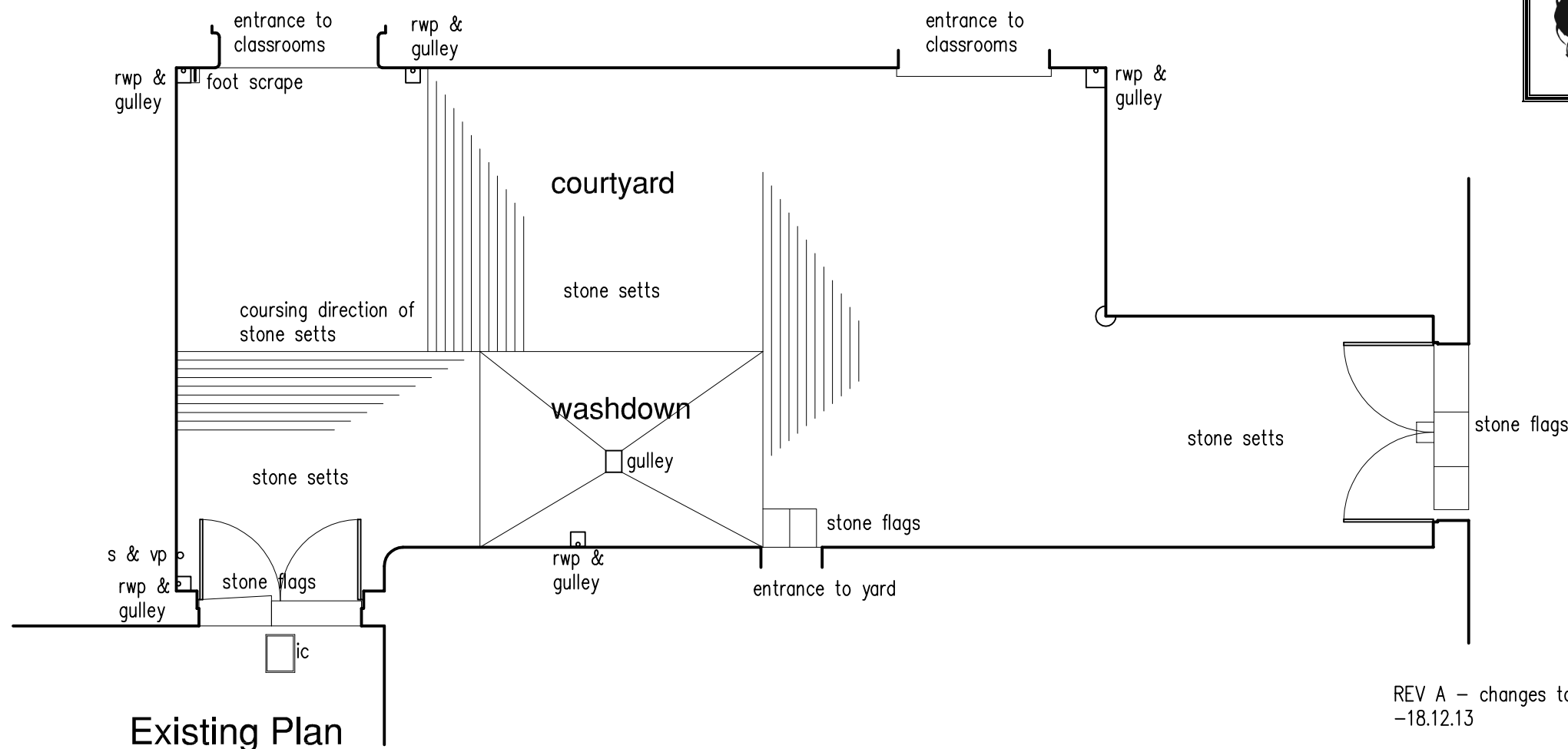

**Existing Plan**



take up and relay ex. stone flags to gate entrance

REV A – changes to material spec –18.12.13

This drawing is the property of Stephen Craven Building Design Limited. Copyright is reserved and the drawing is issued on condition that it is not copied wholly or in part without the consent in writing of Stephen Craven Building Design Limited.

Dimensions should not be scaled. All dimensions to be checked on site by the contractor before commencement of the relevant part of the work.

**MATERIALS**

Setts: take up existing limestone setts and retain on site for re-use; lay well consolidated hardcore sub-base and re-lay existing limestone setts with additional matching reclaimed limestone setts to replace existing defective setts; setts to be tightly packed as per the existing setts and laid on a bed of lime mortar.

Flags: new random sized sandstone paving flags, buff in colour laid on full lime mortar bed over well consolidated hardcore sub-base, flags to be tightly packed.

Lime mortar; NHL lime with a mix of Cardewmires grit sand and good quality grit sand to suit joints and beds.

Sample panels: panels of setts and flags including pointing to be provided on site for YDNPA approval.

Levels: all levels determined on site and to follow line of existing natural falls.

Vehicular access; strengthen sub base with concrete under wheel runs, ensure suitability of stone flag thickness under vehicle runs

**Stephen Craven Building Design**

Chartered Architectural Technologist and Building Design Consultant

Tipperthwaite Barn Paley Green Lane  
Giggleswick Settle BD24 ODZ  
Tel 01729 824754 Mobile 07763 766702  
E-Mail stephen.craven@tiscali.co.uk

<b>job:</b> Proposed External Works to Courtyard Malham Tarn Field Centre Malham Moor, Settle BD24 9PU		
<b>client:</b> Field Studies Council		
<b>drawing:</b>  Detail Design		
<b>scale:</b> 1:100 @ A3	<b>date:</b> 12/13	<b>drawn:</b> smc
<b>job no:</b> 44/2013	<b>drawing no:</b> 01	<b>rev:</b> A